

3.2 Cleaning

To avoid print quality problems, the interior of the printer must be cleaned with every toner container replacement.



Note

Cleaning should be done from time to time to avoid print quality problems.

3.2.1 Printer Interior

To avoid print quality problems due to paper dust and debris, clean the interior of the printer in the following manner.

- 1 Open the printer's top and front covers.

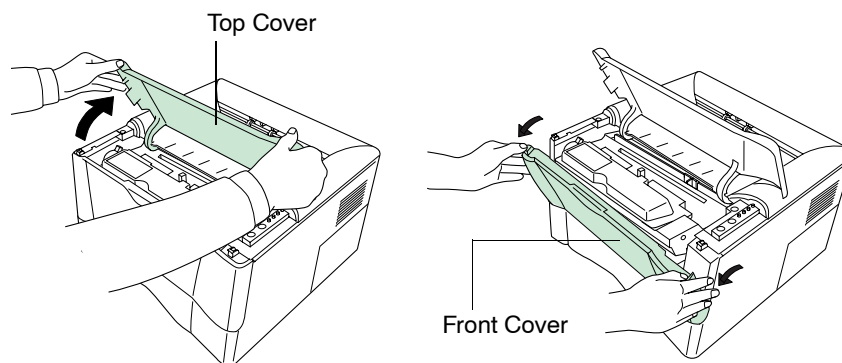

- 2 Lift the process unit together with the toner container out of the printer. **The drum in the process unit is sensitive to light. Never expose the drum even to normal office lighting (500 lux) for more than five minutes.**

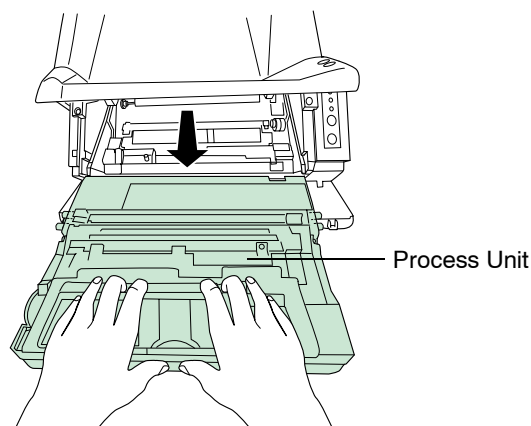



Never stand the process unit on end.

NO

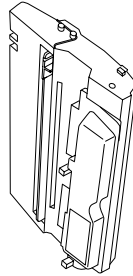

3 Use the supplied wiper cloth to clean dust and dirt away from the registration roller (metal).

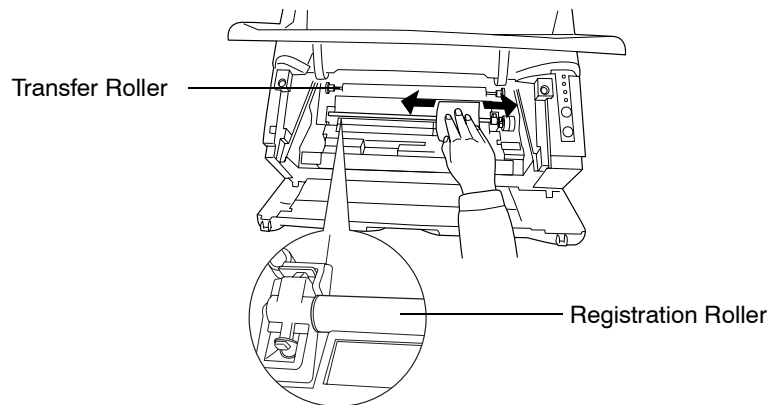

While cleaning, be careful to avoid touching the transfer roller (the black roller).

4 Slide the charger cleaner knob (green-colored) back and forth 2 to 3 times, then return it to its **CLEANER HOME POSITION** ↓.

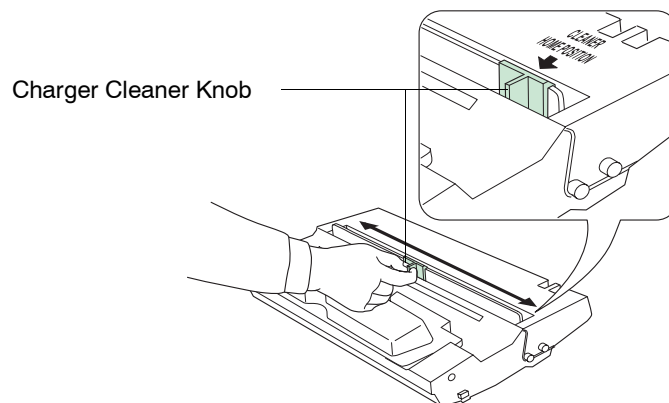

After cleaning, make sure you restore the charger cleaner to its home position.



Note

If the charger cleaner knob is not restored to its home position (marked **CLEANER HOME POSITION ↓**), a black band will print along the length of the page the next time you use the printer.

- 5** After cleaning is done, put the process unit back in the printer. To do so, carefully align the guides at both ends of the process unit with the slots in the printer.

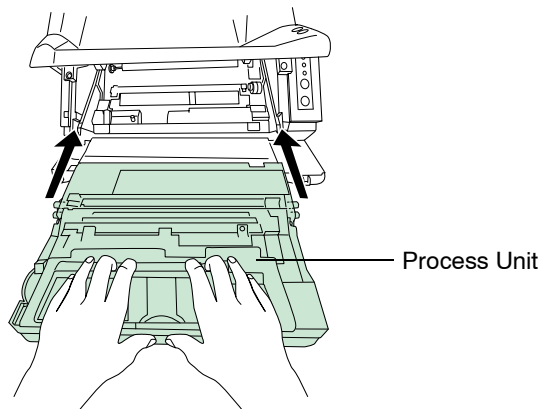

- 6** Close the front cover.

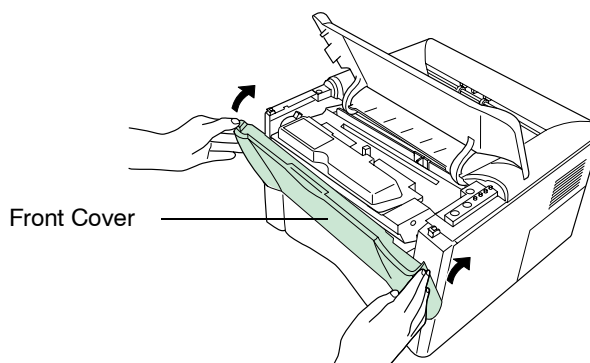

- 7** Close the top cover by pressing down on the front left and right corners of the top cover.

